



**Tooting Sales**, 62 Tooting High Street, London SW17 0RN  
T 020 8772 7200 E [tootsales@ludlowthompson.com](mailto:tootsales@ludlowthompson.com) W [www.ludlowthompson.com](http://www.ludlowthompson.com)

## MITCHAM ROAD CROYDON



**£389,950 FOR SALE**

**REF: 2438566**

### **3 Bed, Terraced House, Private Garden**

**Close proximity to West Croydon Station - Scope to Extend (STPP) - Three Double Bedrooms - Large Eat-in kitchen -**

A three bedroom house located within close proximity to West Croydon and Croydon town centre. The property offers three double bedrooms, a large kitchen/dining area, family bathroom, down stairs WC and homely reception room. The garden and loft provide scope to extend (subject to planning). This house is perfect for a young family looking to grow into it. To arrange a viewing please contact a member of our sales team on 0208 722 7200.

**Train/Tube - West Croydon, East Croydon, Waddon, Therapia Lane**

**Local Authority/Council Tax - Croydon**

**Tenure - Freehold**

**ludlowthompson**



**Tooting Sales**, 62 Tooting High Street, London SW17 0RN  
T 020 8772 7200 E [tootsales@ludlowthompson.com](mailto:tootsales@ludlowthompson.com) W [www.ludlowthompson.com](http://www.ludlowthompson.com)

# MITCHAM ROAD CROYDON



Reception Room



Reception alt



Kitchen/Diner



Kitchen



Bedroom 2



Bedroom 1



**Tooting Sales**, 62 Tooting High Street, London SW17 0RN  
T 020 8772 7200 E [tootsales@ludlowthompson.com](mailto:tootsales@ludlowthompson.com) W [www.ludlowthompson.com](http://www.ludlowthompson.com)

# MITCHAM ROAD CROYDON



Bedroom 3



External



# MITCHAM ROAD CROYDON

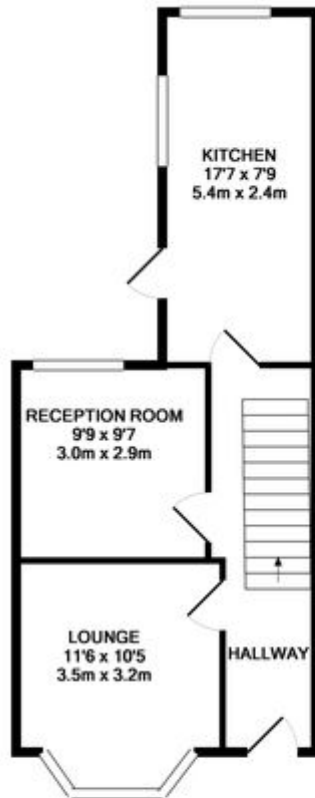

GROUND FLOOR  
APPROX. FLOOR  
AREA 438 SQ.FT.  
(40.7 SQ.M.)



1ST FLOOR  
APPROX. FLOOR  
AREA 436 SQ.FT.  
(40.5 SQ.M.)

TOTAL APPROX. FLOOR AREA 874 SQ.FT. (81.2 SQ.M.)

Whilst every attempt has been made to ensure the accuracy of the floor plan contained here, measurements of doors, windows, rooms and any other items are approximate and no responsibility is taken for any error, omission, or mis-statement. This plan is for illustrative purposes only and should be used as such by any prospective purchaser. The services, systems and appliances shown have not been tested and no guarantee as to their operability or efficiency can be given  
Made with Metropix ©2018

Please note that this floor plan is produced for illustration and identification purposes only. It is NOT drawn to a scale. Measurements are taken in accordance with the R.I.C.S. Code of Measurement Practice. Areas quoted are Gross Internal Areas as per the R.I.C.S. Code and are not guaranteed. Do not use this plan to buy or place furniture or furnishings. Rely upon your own measurements only. Areas quoted are only a guide.



**Tooting Sales**, 62 Tooting High Street, London SW17 0RN  
T 020 8772 7200 E [tootsales@ludlowthompson.com](mailto:tootsales@ludlowthompson.com) W [www.ludlowthompson.com](http://www.ludlowthompson.com)

# MITCHAM ROAD CROYDON





# MITCHAM ROAD CROYDON

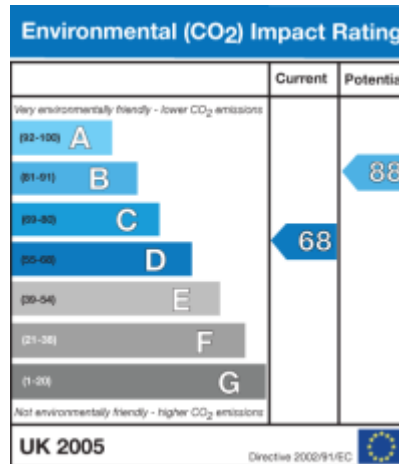
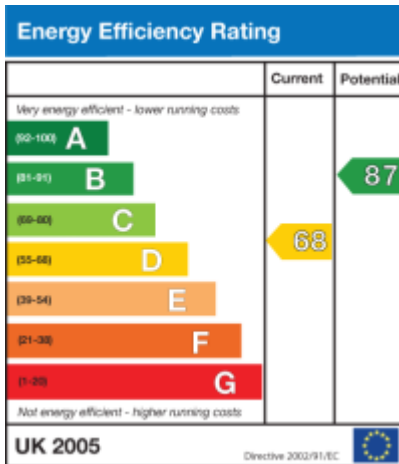



**Tooting Sales**, 62 Tooting High Street, London SW17 0RN  
T 020 8772 7200 E [tootsales@ludlowthompson.com](mailto:tootsales@ludlowthompson.com) W [www.ludlowthompson.com](http://www.ludlowthompson.com)

# MITCHAM ROAD CROYDON



**CALL 020 8772 7200**

**REF: 2438566**

## **When you want to view a property through us it helps to bear in mind the following:**

Viewings are a limited opportunity and therefore should be undertaken seriously. It might be necessary to take a flexible approach in the time arrangement of viewings. Sometimes a vendor will give us specific times only convenient to them. We do advise vendors that if they are serious about selling property they should be as flexible as possible. We normally keep keys and can therefore access the property pretty much anytime.

**To arrange a viewing for this property please contact our Tooting Sales Office quoting 2438566**

## **DISCLAIMER**

**VIEWING:** strictly by appointment through LUDLOWTHOMPSON. ludlowthompson are Agents for themselves and for the vendor.

1. These particulars do not form any part of any offer or contract.
2. Particulars are intended to give a fair description only. ludlowthompson/vendor accept no responsibility for any error they may contain however caused. Any purchaser must satisfy her/himself by inspection or otherwise as to their correctness.
3. ludlowthompson or employees have no authority to make or give any representation or warranty whatever regarding this property.

## **PLEASE NOTE BEFORE PROCEEDING**

We have been unable to confirm the terms of tenure, we have relied upon information supplied by the vendor. Photographs may depict items which are not included in the sale. Consult a solicitor on aspects relating to tenure/property details.