



City / Docklands Lettings, 3-5 Dock Street, London E1 8JN
T 020 7480 0120 E docklet@ludlowthompson.com W www.ludlowthompson.com

BRADY STREET WHITECHAPEL



LET

REF: 4913209

1 Bed, Complex Apartment, Communal Garden

Modern Kitchen and Bathroom - Open Plan Living Space - Great Transport Links - One Bedroom Property - Fully Furnished - Cheap Council Tax

A one bedroom apartment within this ex local authority building in Brady Street, E1. The property is finished to a very good standard, and comprises; reception room with open plan kitchen, double bedroom, and modern three piece bathroom suite. Located ideally for easy access into the City and Canary Wharf, with an abundance of local amenities, including the shops, bars and restaurants of Shoreditch and Brick Lane as well the upcoming Whitechapel Crossrail station due to open soon.

Train/Tube - Tower Gateway, Tower Hill, Aldgate East, Aldgate



City / Docklands Lettings, 3-5 Dock Street, London E1 8JN
T 020 7480 0120 E docklet@ludlowthompson.com W www.ludlowthompson.com

BRADY STREET WHITECHAPEL



Kitchen



Reception Alt



Bathroom



Bedroom



Bedroom Alt



High Street



City / Docklands Lettings, 3-5 Dock Street, London E1 8JN
T 020 7480 0120 E docket@ludlowthompson.com W www.ludlowthompson.com

BRADY STREET WHITECHAPEL



External



Market



BRADY STREET WHITECHAPEL

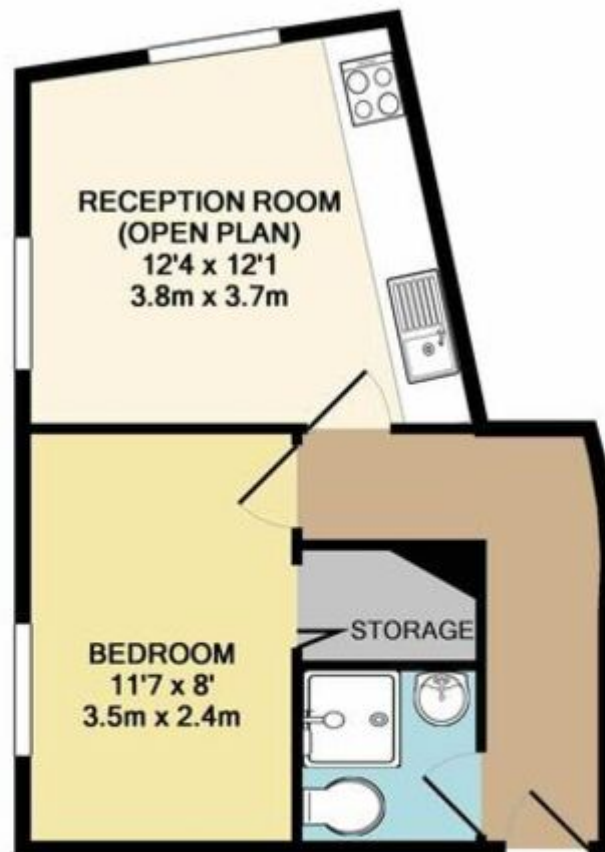

TOTAL APPROX. FLOOR AREA 359 SQ.FT. (33.4 SQ.M.)

Whilst every attempt has been made to ensure the accuracy of the floor plan contained here, measurements of doors, windows, rooms and any other items are approximate and no responsibility is taken for any error, omission, or mis-statement. This plan is for illustrative purposes only and should be used as such by any prospective purchaser. The services, systems and appliances shown have not been tested and no guarantee as to their operability or efficiency can be given
Made with Metropix ©2018

Please note that this floor plan is produced for illustration and identification purposes only. It is NOT drawn to a scale. Measurements are taken in accordance with the R.I.C.S. Code of Measurement Practice. Areas quoted are Gross Internal Areas as per the R.I.C.S. Code and are not guaranteed. Do not use this plan to buy or place furniture or furnishings. Rely upon your own measurements only. Areas quoted are only a guide.



City / Docklands Lettings, 3-5 Dock Street, London E1 8JN
T 020 7480 0120 E docket@ludlowthompson.com W www.ludlowthompson.com

BRADY STREET WHITECHAPEL





BRADY STREET WHITECHAPEL

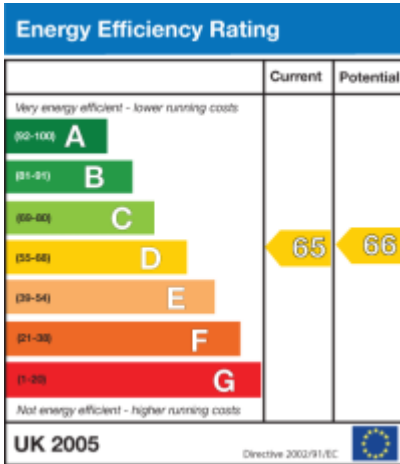



BRADY STREET WHITECHAPEL

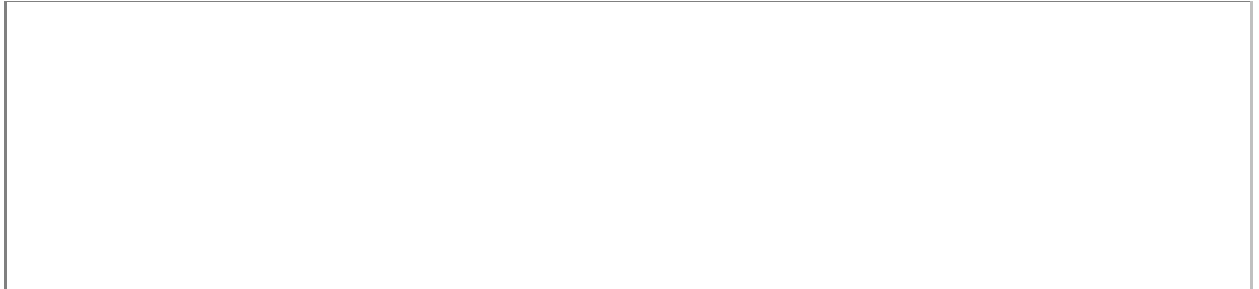

CALL 020 7480 0120

REF: 4913209

When you want to view a property through us it helps to bear in mind the following:

Viewings are a limited opportunity and therefore should be undertaken seriously. It might be necessary to take a flexible approach in the time arrangement of viewings. Sometimes a landlord will give us specific times only convenient to them. We do advise landlords that if they are serious about letting property they should be as flexible as possible. We normally keep keys and can therefore access the property pretty much anytime.

To arrange a viewing for this property please contact our City / Docklands Lettings Office quoting 4913209

DISCLAIMER

VIEWING: strictly by appointment through LUDLOWTHOMPSON. ludlowthompson are Agents for themselves and for the landlord.

1. These particulars do not form any part of any offer or contract.
2. Particulars are intended to give a fair description only. ludlowthompson/landlord accept no responsibility for any error they may contain however caused. Any renter must satisfy her/himself by inspection or otherwise as to their correctness.
3. ludlowthompson or employees have no authority to make or give any representation or warranty whatever regarding this property.

PLEASE NOTE BEFORE PROCEEDING

We have been unable to confirm the terms of tenure, we have relied upon information supplied by the landlord. Photographs may depict items which are not included in the let. Consult a solicitor on aspects relating to tenure/property details.