



Acton Lettings.

WESTWAY WHITE CITY



SOLD

REF: 398766

3 Bed, Terraced House, Private Garden, Off Street Parking

Private Rear Garden - Fully Double Glazed - Extended Property - Walking Distance To East Acton Station -

Westway: A bright and spacious, extended three bedroom terrace house. The property is well presented with a good size garden. The property is very well located for the A40 being on the west way. Multiple shopping and transport facilities are within walking distance, as well as East Acton Underground station. To see more details and to arrange a viewing log on to ludlowthompson.com or call 020 8752 9999.

Train/Tube - White City, Shepherds Bush (H&C), Latimer Rd, East Acton

Local Authority/Council Tax - Hammersmith & Fulham

Tenure - Freehold

ludlowthompson



WESTWAY WHITE CITY



Reception One



Reception Two



Kitchen



Master Bedroom



Bedroom Two



Bedroom Three



WESTWAY WHITE CITY



Garden



Reception



WESTWAY WHITE CITY



GROUND FLOOR
APPROX. FLOOR
AREA 591 SQ.FT.
(54.9 SQ.M.)

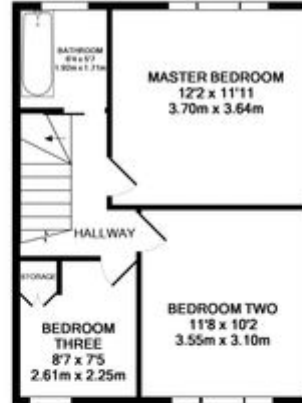

1ST FLOOR
APPROX. FLOOR
AREA 418 SQ.FT.
(38.8 SQ.M.)
TOTAL APPROX. FLOOR AREA 1009 SQ.FT. (93.7 SQ.M.)
Made with Metropix ©2011

Please note that this floor plan is produced for illustration and identification purposes only. It is NOT drawn to a scale. Measurements are taken in accordance with the R.I.C.S. Code of Measurement Practice. Areas quoted are Gross Internal Areas as per the R.I.C.S. Code and are not guaranteed. Do not use this plan to buy or place furniture or furnishings. Rely upon your own measurements only. Areas quoted are only a guide.



WESTWAY WHITE CITY



Reception One

The reception room has lots of natural light and has neutral decor.

Reception Two

Kitchen

The present owners have extended the property at the rear with an addition of a modern fitted kitchen/breakfast room comprising a single drainer sink unit set in work top, range of wall and base units with drawer and cupboard space, space for fridge/freezer, ceramic tiled splash backs, power points.

Master Bedroom

Bedroom Two

Bedroom Three

Garden



WESTWAY WHITE CITY

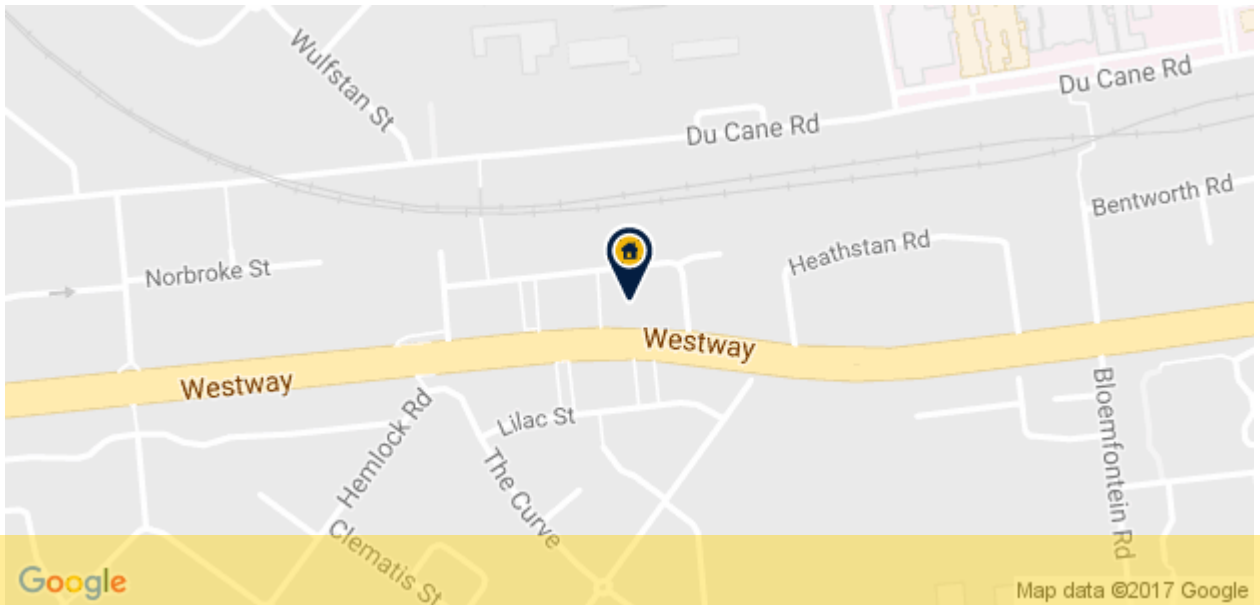

REF: 398766

When you want to view a property through us it helps to bear in mind the following:

Viewings are a limited opportunity and therefore should be undertaken seriously. It might be necessary to take a flexible approach in the time arrangement of viewings. Sometimes a vendor will give us specific times only convenient to them. We do advise vendors that if they are serious about selling property they should be as flexible as possible. We normally keep keys and can therefore access the property pretty much anytime.

To arrange a viewing for this property please contact our Acton Lettings Office quoting 398766

DISCLAIMER

VIEWING: strictly by appointment through LUDLOWTHOMPSON. ludlowthompson are Agents for themselves and for the vendor.

1. These particulars do not form any part of any offer or contract.
2. Particulars are intended to give a fair description only. ludlowthompson/vendor accept no responsibility for any error they may contain however caused. Any purchaser must satisfy her/himself by inspection or otherwise as to their correctness.
3. ludlowthompson or employees have no authority to make or give any representation or warranty whatever regarding this property.

PLEASE NOTE BEFORE PROCEEDING

We have been unable to confirm the terms of tenure, we have relied upon information supplied by the vendor. Photographs may depict items which are not included in the sale. Consult a solicitor on aspects relating to tenure/property details.