



Finsbury Park Sales, 8 Blackstock Road, London N4 2DL

T 020 7704 5788 E finsburysales@ludlowthompson.com W www.ludlowthompson.com

# TRENTHAM COURT ACTON



**SOLD**

**REF: 461948**

## 1 Bed, Complex Apartment, Communal Garden

Concierge Service - Moments from North Acton Station - South Facing Apartment - Modern One Bedroom Apartment - 946 Yearr Lease - Open-Plan Living

Ludlowthompson are happy to present this gorgeous, south facing one bedroom apartment situated in this secure, modern development on Victoria Road, moments from North Acton Station (Central line Zone 2). Offered chain free, and benefiting from communal gardens, a concierge and along lease. Comprising a generous reception, with a smart, open-plan fitted kitchen, a spacious double bedroom and a well presented bathroom. The apartment is on the 5th floor with great views of London. Brilliantly ... [continued below](#)

**Train/Tube** - West Acton, North Acton, Acton Main Line, East Acton

**Local Authority/Council Tax** - Ealing

**Tenure** - Leasehold

**ludlowthompson**



Finsbury Park Sales, 8 Blackstock Road, London N4 2DL  
T 020 7704 5788 E finsburysales@ludlowthompson.com W www.ludlowthompson.com

# TRENTHAM COURT ACTON



Reception / Kitchen



Reception / Kitchen



Reception / Kitchen



Bedroom



Bedroom



Bathroom



Finsbury Park Sales, 8 Blackstock Road, London N4 2DL  
T 020 7704 5788 E [finsburysales@ludlowthompson.com](mailto:finsburysales@ludlowthompson.com) W [www.ludlowthompson.com](http://www.ludlowthompson.com)

# TRENTHAM COURT ACTON



Exterior



Exterior



Finsbury Park Sales, 8 Blackstock Road, London N4 2DL

T 020 7704 5788 E finsburysales@ludlowthompson.com W www.ludlowthompson.com

# TRENTHAM COURT ACTON



## Trentham Court, W3

Approx. Gross Internal Area = 42.5.0sqm / 457.5sqft

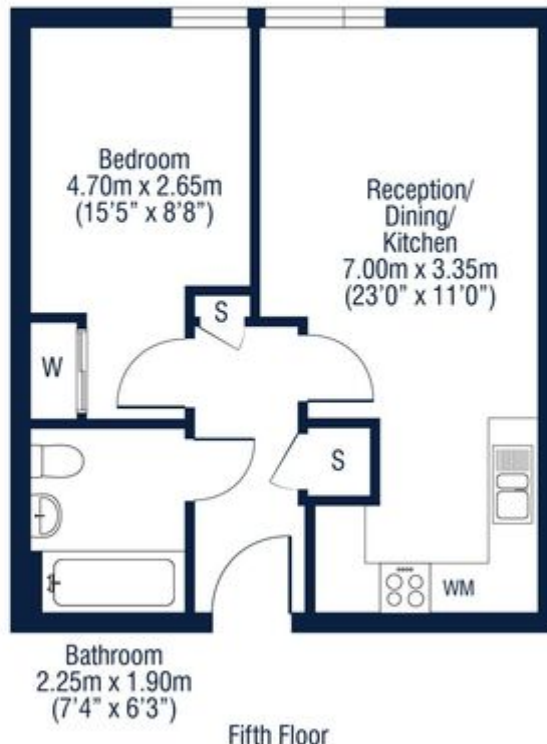

Disclaimer: Floorplan measurements are approximate and are for illustrative purposes only. While we do not doubt the floorplan accuracy and completeness, you or your advisors should conduct a careful, independent investigation of the property in respect of monetary valuation.

Maison  
VUE

Please note that this floor plan is produced for illustration and identification purposes only. It is NOT drawn to a scale. Measurements are taken in accordance with the R.I.C.S. Code of Measurement Practice. Areas quoted are Gross Internal Areas as per the R.I.C.S. Code and are not guaranteed. Do not use this plan to buy or place furniture or furnishings. Rely upon your own measurements only. Areas quoted are only a guide.



Finsbury Park Sales, 8 Blackstock Road, London N4 2DL

T 020 7704 5788 E [finsburysales@ludlowthompson.com](mailto:finsburysales@ludlowthompson.com) W [www.ludlowthompson.com](http://www.ludlowthompson.com)

## TRENTHAM COURT ACTON



Ludlowthompson are happy to present this gorgeous, south facing one bedroom apartment situated in this secure, modern development on Victoria Road, moments from North Acton Station (Central line Zone 2). Offered chain free, and benefiting from communal gardens, a concierge and along lease.

Comprising a generous reception, with a smart, open-plan fitted kitchen, a spacious double bedroom and a well presented bathroom. The apartment is on the 5th floor with great views of London.

Brilliantly situated just across the road from North Acton Underground Station on the Central Line (zone 2). Central London is only 15 minutes away. There is a Tesco right next door, and a number of restaurants, cafes, local shops and green spaces within a short stroll. This amazing location also provides immediate access to the A40 (M).

### Tenure Details

Tenure - Leasehold

Lease Length - 964 years

Service Charges - £2600 per year

Ground Rent - £225 per year



# TRENTHAM COURT ACTON

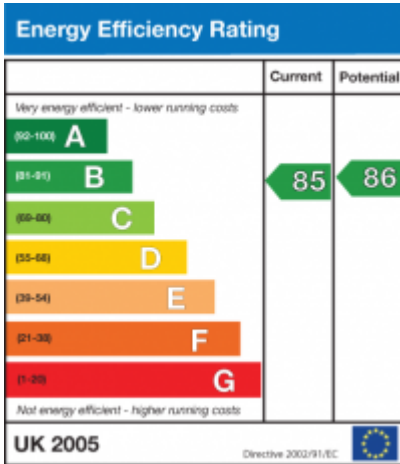



Finsbury Park Sales, 8 Blackstock Road, London N4 2DL

T 020 7704 5788 E finsburysales@ludlowthompson.com W www.ludlowthompson.com

# TRENTHAM COURT ACTON

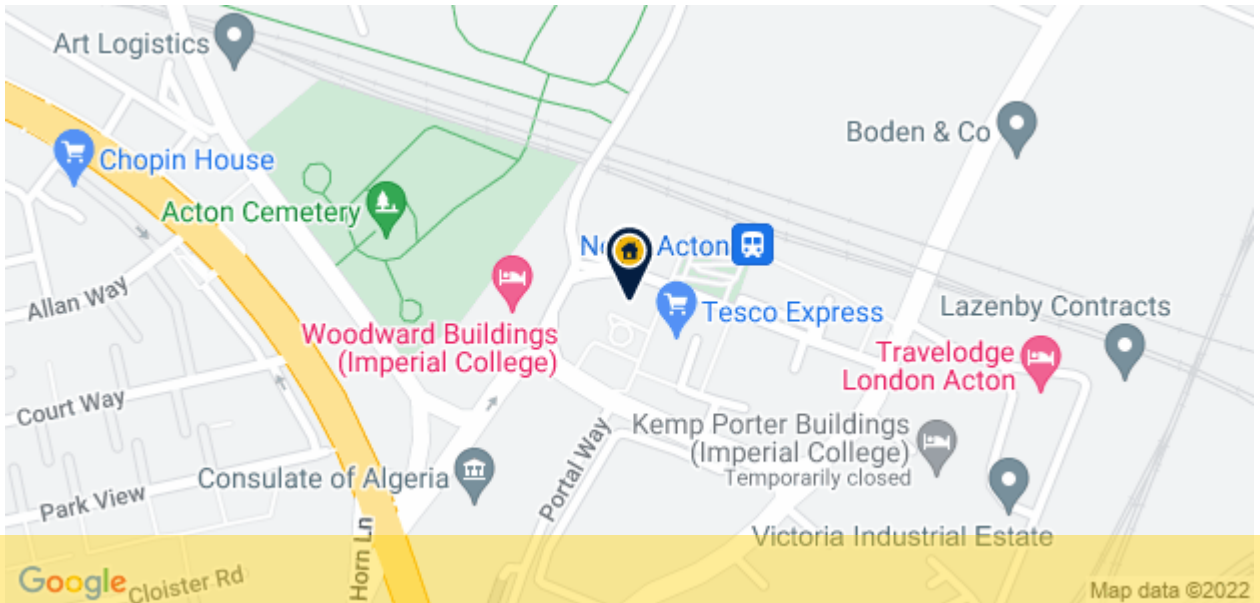

CALL 020 7704 5788

REF: 461948

## When you want to view a property through us it helps to bear in mind the following:

Viewings are a limited opportunity and therefore should be undertaken seriously. It might be necessary to take a flexible approach in the time arrangement of viewings. Sometimes a vendor will give us specific times only convenient to them. We do advise vendors that if they are serious about selling property they should be as flexible as possible. We normally keep keys and can therefore access the property pretty much anytime.

To arrange a viewing for this property please contact our Finsbury Park Sales Office quoting 461948

## DISCLAIMER

VIEWING: strictly by appointment through LUDLOWTHOMPSON. ludlowthompson are Agents for themselves and for the vendor.

1. These particulars do not form any part of any offer or contract.
2. Particulars are intended to give a fair description only. ludlowthompson/vendor accept no responsibility for any error they may contain however caused. Any purchaser must satisfy her/himself by inspection or otherwise as to their correctness.
3. ludlowthompson or employees have no authority to make or give any representation or warranty whatever regarding this property.

## PLEASE NOTE BEFORE PROCEEDING

We have been unable to confirm the terms of tenure, we have relied upon information supplied by the vendor. Photographs may depict items which are not included in the sale. Consult a solicitor on aspects relating to tenure/property details.