



WULFSTAN STREET EAST ACTON



SOLD

REF: 470794

3 Bed, House, Private Garden

Three Double Bedrooms - 1 minute to East Acton Tube - Spacious House - Fantastic Private Garden -

Wulfstan Street, W3..Ludlowthompson. An end of terrace three bedroom house round the corner from East Acton Tube station. The house comprises of a semi open kitchen and reception room with access to the garden via the kitchen. There is an additional reception room/bedroom and toilet on the ground floor. Upstairs there are a further two large and one small double along with a family bathroom with power shower. The property is ideally situated within a few minutes walk of East Acton Underground ... [continued below](#)

Train/Tube - North Acton, West Acton, Acton Main Line, East Acton

Local Authority/Council Tax - Hammersmith & Fulham

Tenure - Freehold

ludlowthompson



WULFSTAN STREET EAST ACTON



Kitchen



Reception Room



Bedroom



WULFSTAN STREET EAST ACTON



GROUND FLOOR
APPROX. FLOOR
AREA 423 SQ.FT.
(39.3 SQ.M.)

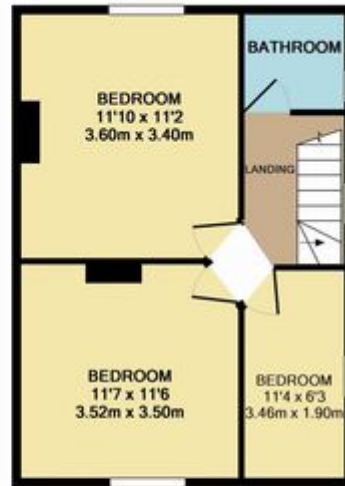

1ST FLOOR
APPROX. FLOOR
AREA 417 SQ.FT.
(38.8 SQ.M.)
TOTAL APPROX. FLOOR AREA 841 SQ.FT. (78.1 SQ.M.)
Made with Metropix 62012

Please note that this floor plan is produced for illustration and identification purposes only. It is NOT drawn to a scale. Measurements are taken in accordance with the R.I.C.S. Code of Measurement Practice. Areas quoted are Gross Internal Areas as per the R.I.C.S. Code and are not guaranteed. Do not use this plan to buy or place furniture or furnishings. Rely upon your own measurements only. Areas quoted are only a guide.



WULFSTAN STREET EAST ACTON



Wulfstan Street, W3..Ludlowthompson. An end of terrace three bedroom house round the corner from East Acton Tube station. The house comprises of a semi open kitchen and reception room with access to the garden via the kitchen. There is an additional reception room/bedroom and toilet on the ground floor. Upstairs there are a further two large and one small double along with a family bathroom with power shower. The property is ideally situated within a few minutes walk of East Acton Underground Station (Central Line, Zone 2), and a few minutes drive to the A40 in and out of Central London. This property would make an ideal buy to let investment. Call Ludlowthomspon Sales in Acton to arrange a viewing.

Kitchen

Reception Room

Bedroom



WULFSTAN STREET EAST ACTON

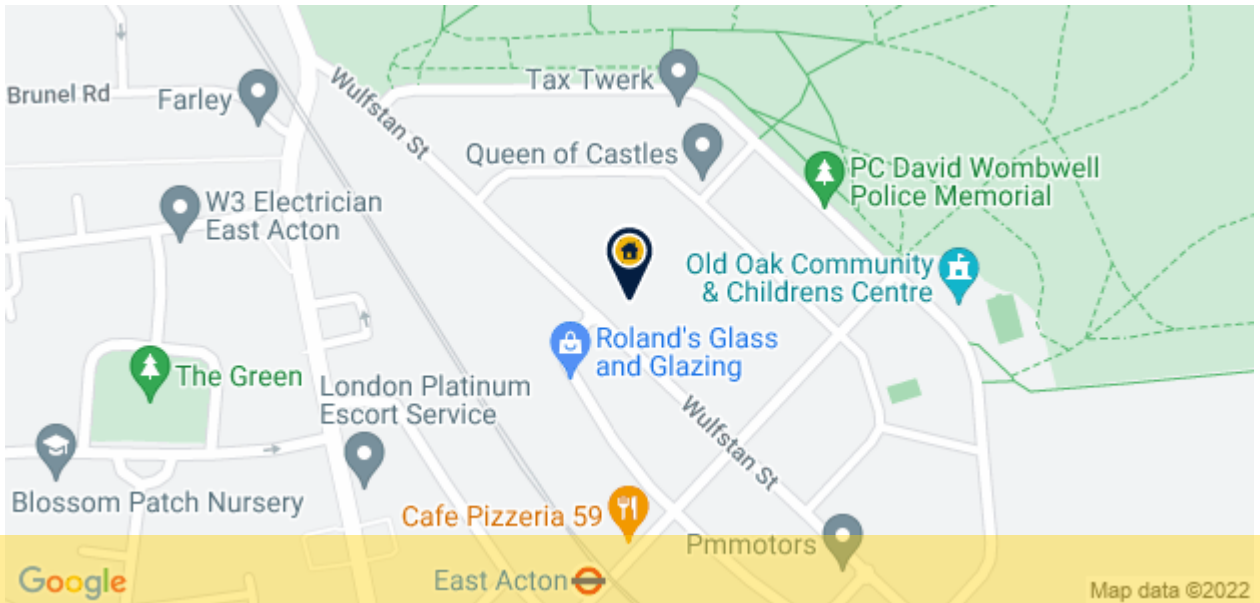

REF: 470794

When you want to view a property through us it helps to bear in mind the following:

Viewings are a limited opportunity and therefore should be undertaken seriously. It might be necessary to take a flexible approach in the time arrangement of viewings. Sometimes a vendor will give us specific times only convenient to them. We do advise vendors that if they are serious about selling property they should be as flexible as possible. We normally keep keys and can therefore access the property pretty much anytime.

To arrange a viewing for this property please contact our Acton Lettings Office quoting 470794

DISCLAIMER

VIEWING: strictly by appointment through LUDLOWTHOMPSON. ludlowthompson are Agents for themselves and for the vendor.

1. These particulars do not form any part of any offer or contract.
2. Particulars are intended to give a fair description only. ludlowthompson/vendor accept no responsibility for any error they may contain however caused. Any purchaser must satisfy her/himself by inspection or otherwise as to their correctness.
3. ludlowthompson or employees have no authority to make or give any representation or warranty whatever regarding this property.

PLEASE NOTE BEFORE PROCEEDING

We have been unable to confirm the terms of tenure, we have relied upon information supplied by the vendor. Photographs may depict items which are not included in the sale. Consult a solicitor on aspects relating to tenure/property details.