



Acton Lettings, 172 High Street, Acton, London W3 9NN
T 020 8752 9988 E actonlet@ludlowthompson.com W www.ludlowthompson.com

PARK ROAD EAST SOUTH ACTON



LET

REF: 561863

1 Bed, High Rise Apartment, Communal Garden

Brick built low rise development - Communal Garden - Cash Purchase Only - Spacious One Bedroom Apartment - Acton Town (District & Piccadilly Underground) - Chain Free

Ludlow Court, W3. A spacious one bedroom apartment close to Acton High Street and Acton Town Tube station in need of some modernisation. The property is situated on the third floor of this block with an elevator. The apartment benefits from excellent views towards the city. The apartment consists of a double bedroom, large reception room, eat in kitchen and bathroom this property would only suit a cash purchaser. Call Ludlowthompson Sales 02087529999

Train/Tube - South Acton, Drayton Park, Acton Central, Acton Town



Acton Lettings, 172 High Street, Acton, London W3 9NN
T 020 8752 9988 E actonlet@ludlowthompson.com W www.ludlowthompson.com

PARK ROAD EAST SOUTH ACTON



Reception Room



Bedroom



Kitchen



Front Shot



View from reception room



Exterior



PARK ROAD EAST SOUTH ACTON

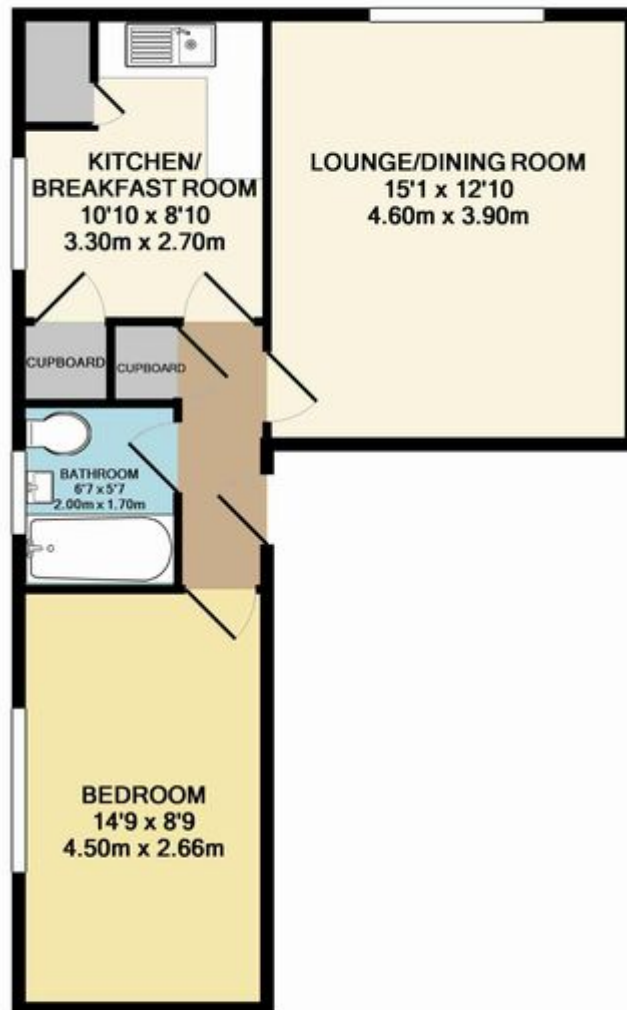

TOTAL APPROX. FLOOR AREA 502 SQ.FT. (46.7 SQ.M.)
Made with Metropix ©2012

Please note that this floor plan is produced for illustration and identification purposes only. It is NOT drawn to a scale. Measurements are taken in accordance with the R.I.C.S. Code of Measurement Practice. Areas quoted are Gross Internal Areas as per the R.I.C.S. Code and are not guaranteed. Do not use this plan to buy or place furniture or furnishings. Rely upon your own measurements only. Areas quoted are only a guide.



Acton Lettings, 172 High Street, Acton, London W3 9NN
T 020 8752 9988 E actonlet@ludlowthompson.com W www.ludlowthompson.com

PARK ROAD EAST SOUTH ACTON



Reception Room - 3.9m x 4.6m (12' 9" x 15' 1")

Bedroom - 2.66m x 4.5m (8' 8" x 14' 9")



PARK ROAD EAST SOUTH ACTON



CALL 020 8752 9988

REF: 561863

When you want to view a property through us it helps to bear in mind the following:

Viewings are a limited opportunity and therefore should be undertaken seriously. It might be necessary to take a flexible approach in the time arrangement of viewings. Sometimes a landlord will give us specific times only convenient to them. We do advise landlords that if they are serious about letting property they should be as flexible as possible. We normally keep keys and can therefore access the property pretty much anytime.

To arrange a viewing for this property please contact our Acton Lettings Office quoting 561863

DISCLAIMER

VIEWING: strictly by appointment through LUDLOWTHOMPSON. ludlowthompson are Agents for themselves and for the landlord.

1. These particulars do not form any part of any offer or contract.
2. Particulars are intended to give a fair description only. ludlowthompson/landlord accept no responsibility for any error they may contain however caused. Any renter must satisfy her/himself by inspection or otherwise as to their correctness.
3. ludlowthompson or employees have no authority to make or give any representation or warranty whatever regarding this property.

PLEASE NOTE BEFORE PROCEEDING

We have been unable to confirm the terms of tenure, we have relied upon information supplied by the landlord. Photographs may depict items which are not included in the let. Consult a solicitor on aspects relating to tenure/property details.