



**Tooting Sales**, 62 Tooting High Street, London SW17 0RN  
T 020 8772 7200 E [tootsales@ludlowthompson.com](mailto:tootsales@ludlowthompson.com) W [www.ludlowthompson.com](http://www.ludlowthompson.com)

## GRANGE YARD BERMONDSEY



**SOLD**

**REF: 852638**

### **1 Bed, Purpose Built Apartment, 1 Underground Parking Space**

**Loft Style Apartment - Bright and spacious - One bedroom - Secure Underground Parking - No onward chain**

A bright and spacious loft apartment situated in a modern warehouse style building. Boasting high ceilings, large windows that flood the property with natural light and wooden floors. The desirable one bed apartment comprises of a large reception, fitted kitchen, modern tiled bathroom, bedroom and an allocated underground parking space. Skyline Court is ideally located within easy reach of the trendy bars, restaurants, gastro pubs and eateries of Bermondsey Street, Borough Market, Shad Thames... **continued below**

**Train/Tube** - Bermondsey, London Bridge, Borough, South Bermondsey

**Local Authority/Council Tax** - Southwark

**Tenure** - Leasehold

**ludlowthompson**



**Tooting Sales**, 62 Tooting High Street, London SW17 0RN  
T 020 8772 7200 E [tootsales@ludlowthompson.com](mailto:tootsales@ludlowthompson.com) W [www.ludlowthompson.com](http://www.ludlowthompson.com)

# GRANGE YARD BERMONDSEY



Reception view1



Reception view2



Bedroom



Bathroom



External



# GRANGE YARD BERMONDSEY

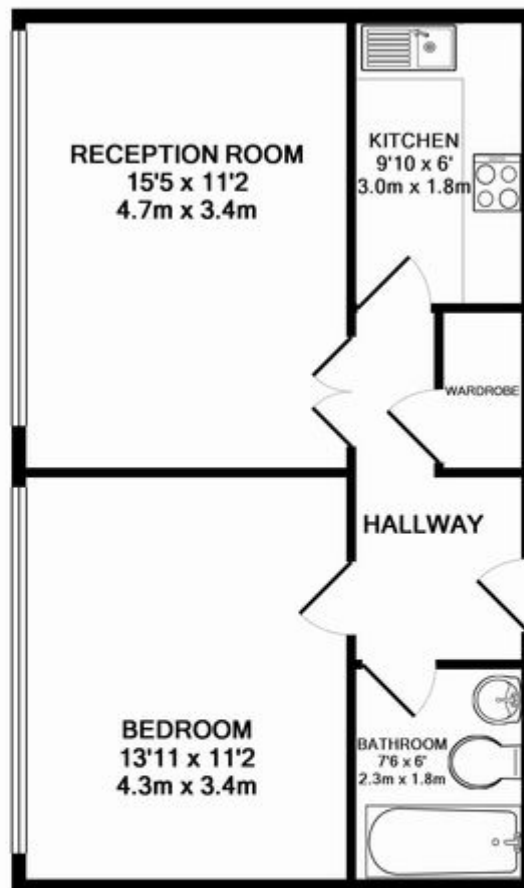

TOTAL APPROX. FLOOR AREA 503 SQ.FT. (46.8 SQ.M.)

Whilst every attempt has been made to ensure the accuracy of the floor plan contained here, measurements of doors, windows, rooms and any other items are approximate and no responsibility is taken for any error, omission, or mis-statement. This plan is for illustrative purposes only and should be used as such by any prospective purchaser. The services, systems and appliances shown have not been tested and no guarantee as to their operability or efficiency can be given  
Made with Metropix ©2015

Please note that this floor plan is produced for illustration and identification purposes only. It is NOT drawn to a scale. Measurements are taken in accordance with the R.I.C.S. Code of Measurement Practice. Areas quoted are Gross Internal Areas as per the R.I.C.S. Code and are not guaranteed. Do not use this plan to buy or place furniture or furnishings. Rely upon your own measurements only. Areas quoted are only a guide.



**Tooting Sales**, 62 Tooting High Street, London SW17 0RN  
T 020 8772 7200 E [tootsales@ludlowthompson.com](mailto:tootsales@ludlowthompson.com) W [www.ludlowthompson.com](http://www.ludlowthompson.com)

## GRANGE YARD BERMONDSEY



A bright and spacious loft apartment situated in a modern warehouse style building. Boasting high ceilings, large windows that flood the property with natural light and wooden floors. The desirable one bed apartment comprises of a large reception, fitted kitchen, modern tiled bathroom, bedroom and an allocated underground parking space.

Skyline Court is ideally located within easy reach of the trendy bars, restaurants, gastro pubs and eateries of Bermondsey Street, Borough Market, Shad Thames, St Katherine's Docks and the City. Transport links are excellent, Borough, London Bridge and Bermondsey Stations are all close by and there are numerous bus routes in and out of central London to choose from.

### Tenure Details

Tenure - Leasehold

Lease Length - 983 years

Service Charges - £1700 per year



## GRANGE YARD BERMONDSEY



**CALL 020 8772 7200**

**REF: 852638**

### **When you want to view a property through us it helps to bear in mind the following:**

Viewings are a limited opportunity and therefore should be undertaken seriously. It might be necessary to take a flexible approach in the time arrangement of viewings. Sometimes a vendor will give us specific times only convenient to them. We do advise vendors that if they are serious about selling property they should be as flexible as possible. We normally keep keys and can therefore access the property pretty much anytime.

**To arrange a viewing for this property please contact our Tooting Sales Office quoting 852638**

### **DISCLAIMER**

VIEWING: strictly by appointment through LUDLOWTHOMPSON. ludlowthompson are Agents for themselves and for the vendor.

1. These particulars do not form any part of any offer or contract.
2. Particulars are intended to give a fair description only. ludlowthompson/vendor accept no responsibility for any error they may contain however caused. Any purchaser must satisfy her/himself by inspection or otherwise as to their correctness.
3. ludlowthompson or employees have no authority to make or give any representation or warranty whatever regarding this property.

### **PLEASE NOTE BEFORE PROCEEDING**

We have been unable to confirm the terms of tenure, we have relied upon information supplied by the vendor. Photographs may depict items which are not included in the sale. Consult a solicitor on aspects relating to tenure/property details.