



Kennington / Oval Sales, 12 Clapham Road, London SW9 0JG
T 020 7820 4100 E ovalsales@ludlowthompson.com W www.ludlowthompson.com

GUILDFORD ROAD STOCKWELL



SOLD

REF: 95612

6 Bed, Terraced House, Private Garden

Five Bedrooms - Some Period Features - Vauxhall / Stockwell - Four Storey House - Exotic Gardens - Excellent Local Transport

Elegant Victorian Four Storey Townhouse. The property has been let out on assured short hold tenancies for a number of years and now needs some updating. The accommodation is arranged over four floors and is currently set up as five bedrooms but the House can be rearranged to suit the new owners requirements. There is an impressive top floor area which has been vaulted right up to the roof rafters and overlooking the gardens. Some period features, lots of space and natural light. Located within... **continued below**

Train/Tube - Oval, Clapham North, Stockwell, Vauxhall

Local Authority/Council Tax - Lambeth

Tenure - Freehold

ludlowthompson



Kennington / Oval Sales, 12 Clapham Road, London SW9 0JG
T 020 7820 4100 E ovalsales@ludlowthompson.com W www.ludlowthompson.com

GUILDFORD ROAD STOCKWELL



Kitchen



Lounge



Decking from Kitchen



Garden



GUILDFORD ROAD STOCKWELL

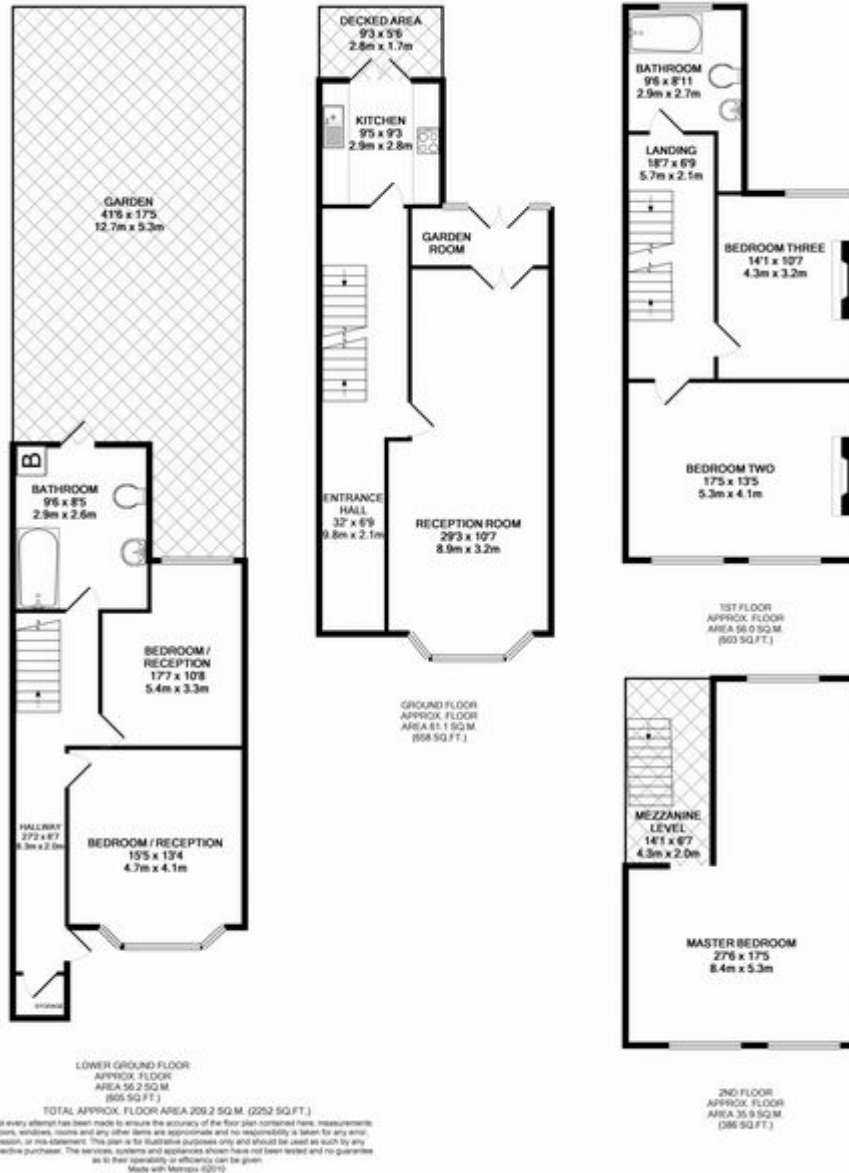

Please note that this floor plan is produced for illustration and identification purposes only. It is NOT drawn to a scale. Measurements are taken in accordance with the R.I.C.S. Code of Measurement Practice. Areas quoted are Gross Internal Areas as per the R.I.C.S. Code and are not guaranteed. Do not use this plan to buy or place furniture or furnishings. Rely upon your own measurements only. Areas quoted are only a guide.



GUILDFORD ROAD STOCKWELL



Elegant Victorian Four Storey Townhouse. The property has been let out on assured short hold tenancies for a number of years and now needs some updating. The accommodation is arranged over four floors and is currently set up as five bedrooms but the House can be rearranged to suit the new owners requirements. There is an impressive top floor area which has been vaulted right up to the roof rafters and overlooking the gardens. Some period features, lots of space and natural light. Located within walking distance of Stockwell and Vauxhall tube, rail and bus terminus. Local amenities include; Little Portugal tapas bars, cafes and delis, Sainsbury Superstore, Gym and Vauxhall Park.



GUILDFORD ROAD STOCKWELL



CALL 020 7820 4100

REF: 95612

When you want to view a property through us it helps to bear in mind the following:

Viewings are a limited opportunity and therefore should be undertaken seriously. It might be necessary to take a flexible approach in the time arrangement of viewings. Sometimes a vendor will give us specific times only convenient to them. We do advise vendors that if they are serious about selling property they should be as flexible as possible. We normally keep keys and can therefore access the property pretty much anytime.

To arrange a viewing for this property please contact our Kennington / Oval Sales Office quoting 95612

DISCLAIMER

VIEWING: strictly by appointment through LUDLOWTHOMPSON. ludlowthompson are Agents for themselves and for the vendor.

1. These particulars do not form any part of any offer or contract.
2. Particulars are intended to give a fair description only. ludlowthompson/vendor accept no responsibility for any error they may contain however caused. Any purchaser must satisfy her/himself by inspection or otherwise as to their correctness.
3. ludlowthompson or employees have no authority to make or give any representation or warranty whatever regarding this property.

PLEASE NOTE BEFORE PROCEEDING

We have been unable to confirm the terms of tenure, we have relied upon information supplied by the vendor. Photographs may depict items which are not included in the sale. Consult a solicitor on aspects relating to tenure/property details.